

★ **Project Location**
 County: Coconino
 City: Flagstaff

Sinclair Wash Restoration Feasibility Study

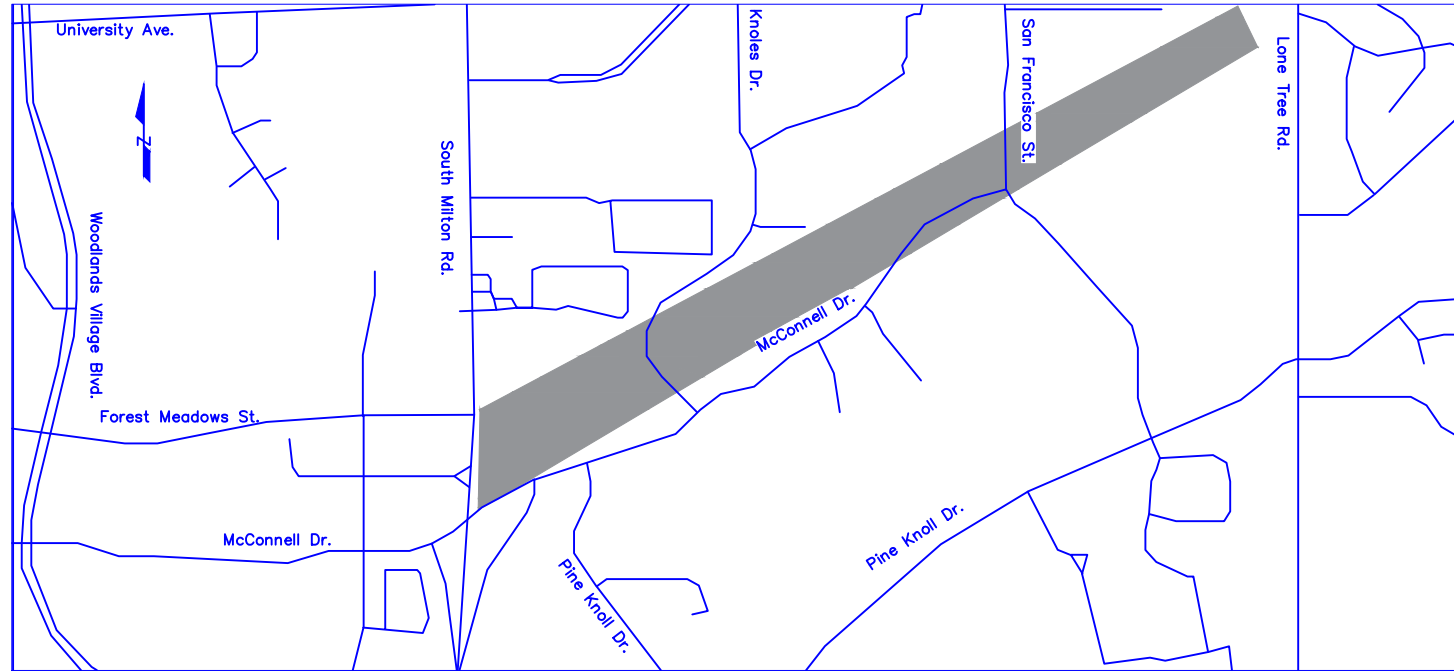

Project Site Map

■ Project Location

List of Sheets

- Sheet 1: Cover Sheet
- Sheet 2: Overall Sheet
- Sheet 3: Typical Detail Sheet
- Sheet 4: Sub reach 1 plan and profile
- Sheet 5: Sub reach 2 plan and profile
- Sheet 6: Sub reach 3 plan and profile
- Sheet 7: Sub reach 1 cross sections
- Sheet 8: Sub reach 2 cross sections
- Sheet 9: Sub reach 3 cross sections

DRAWING:	COVER PAGE	
	PAGE:1	OF:10
BY:HYD ENGINEERING	SCALE:NOT TO SCALE	
DATE: 4/21/2020	REVISION:REVISION	
PROJECT:	SINCLAIR WASH FEASIBILITY STUDY	

PRODUCED BY AN AUTODESK STUDENT VERSION

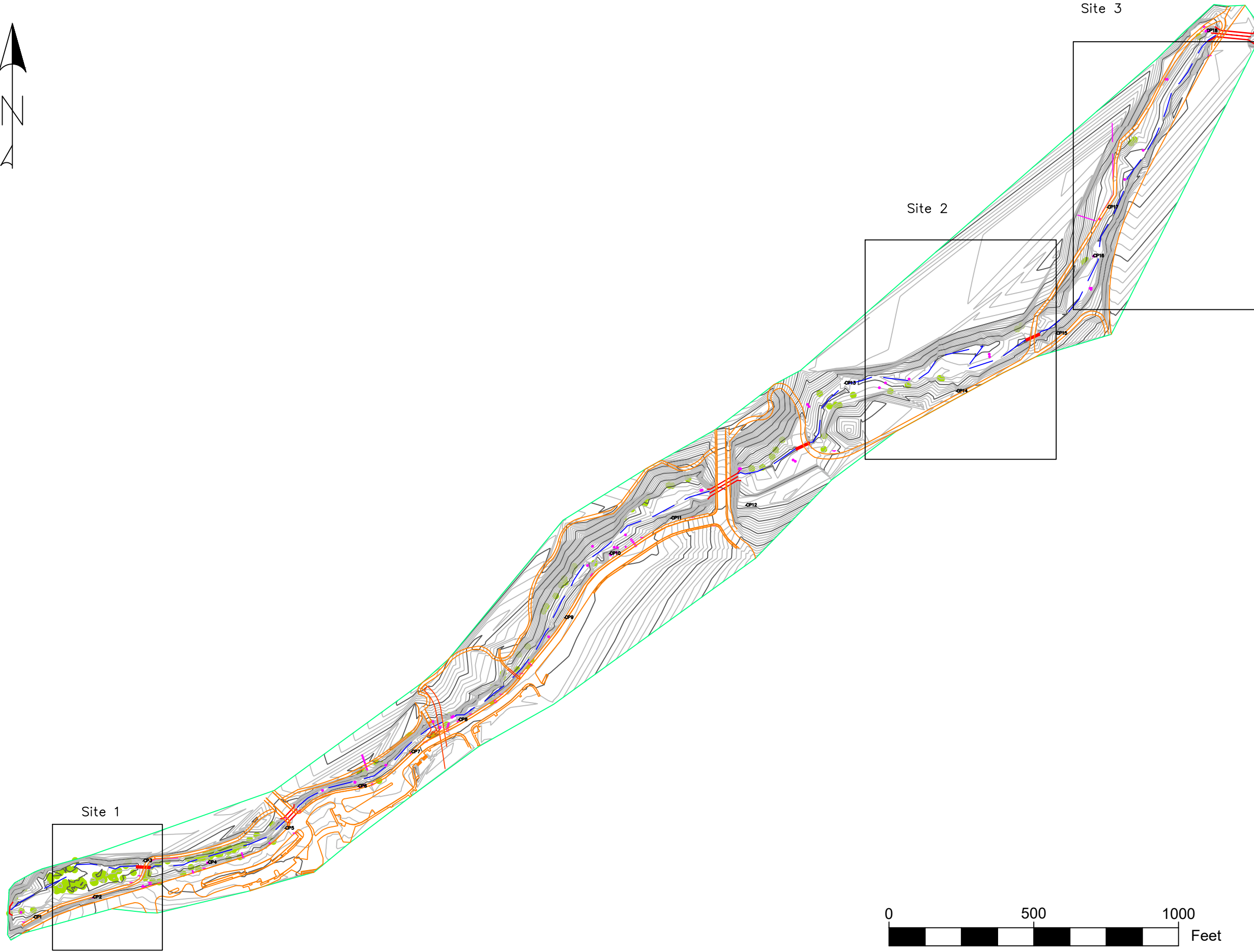

PRODUCED BY AN AUTODESK STUDENT VERSION

PROJECT:	DATE: 4/21/2020	BY: HYD ENGINEERING	DRAWING:
		SCALE: NOT TO SCALE	
SINCLAIR WASH FEASIBILITY STUDY			PAGE: 2
			OF: 10

PRODUCED BY AN AUTODESK STUDENT VERSION

Site 1 Riffle, Run, Pool, Glide Profile (Typ.)

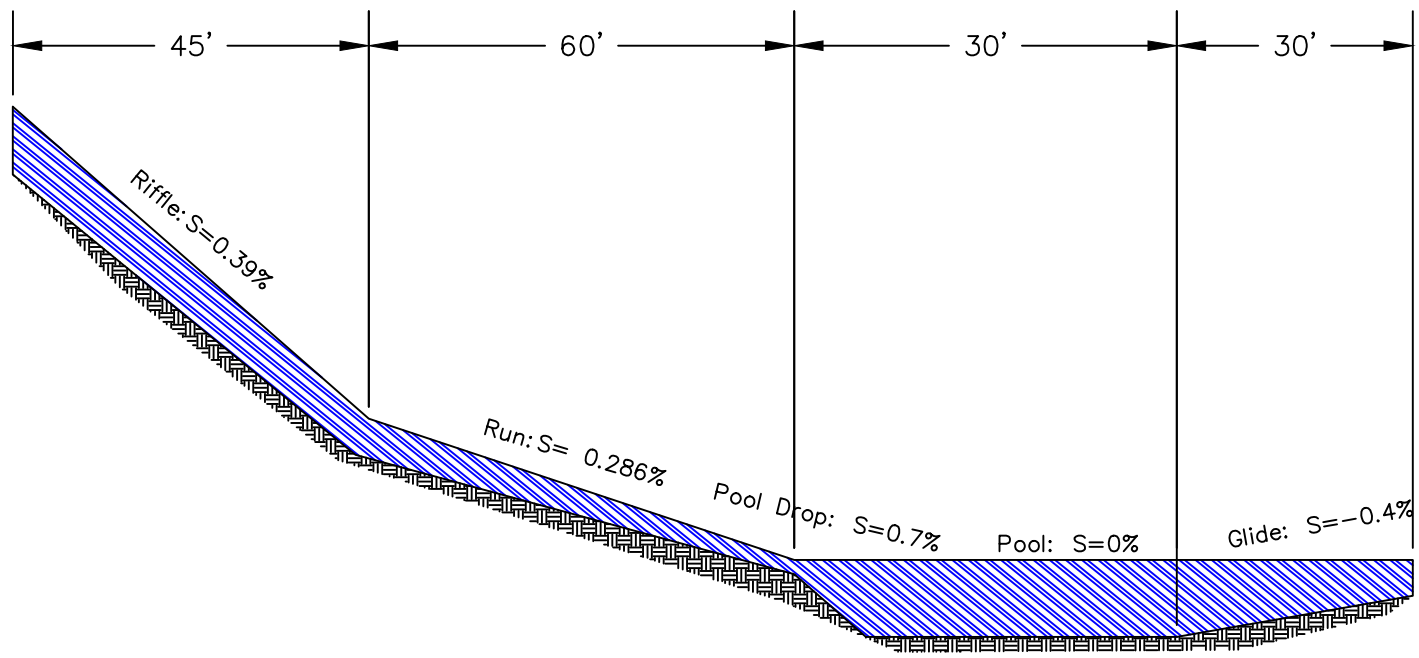

Site 2 Riffle, Run, Pool, Glide Profile (Typ.)

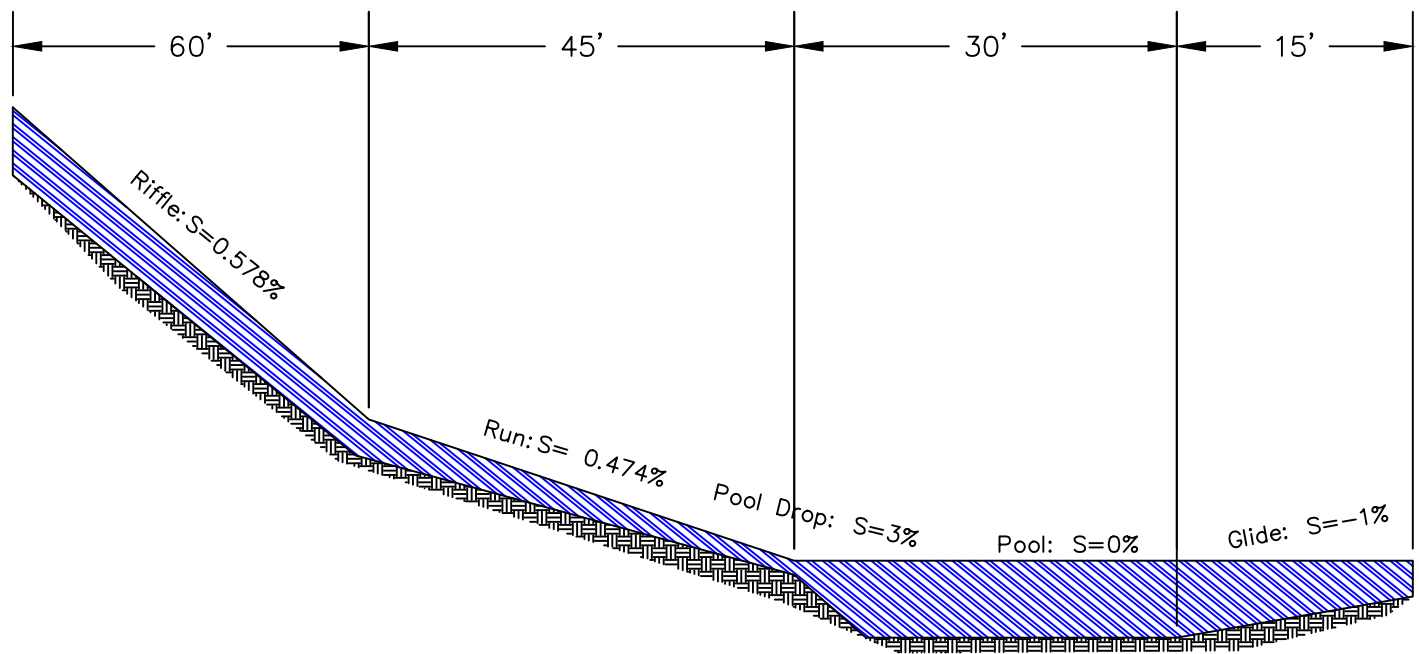

Site 3 Riffle, Run, Pool, Glide Profile (Typ.)

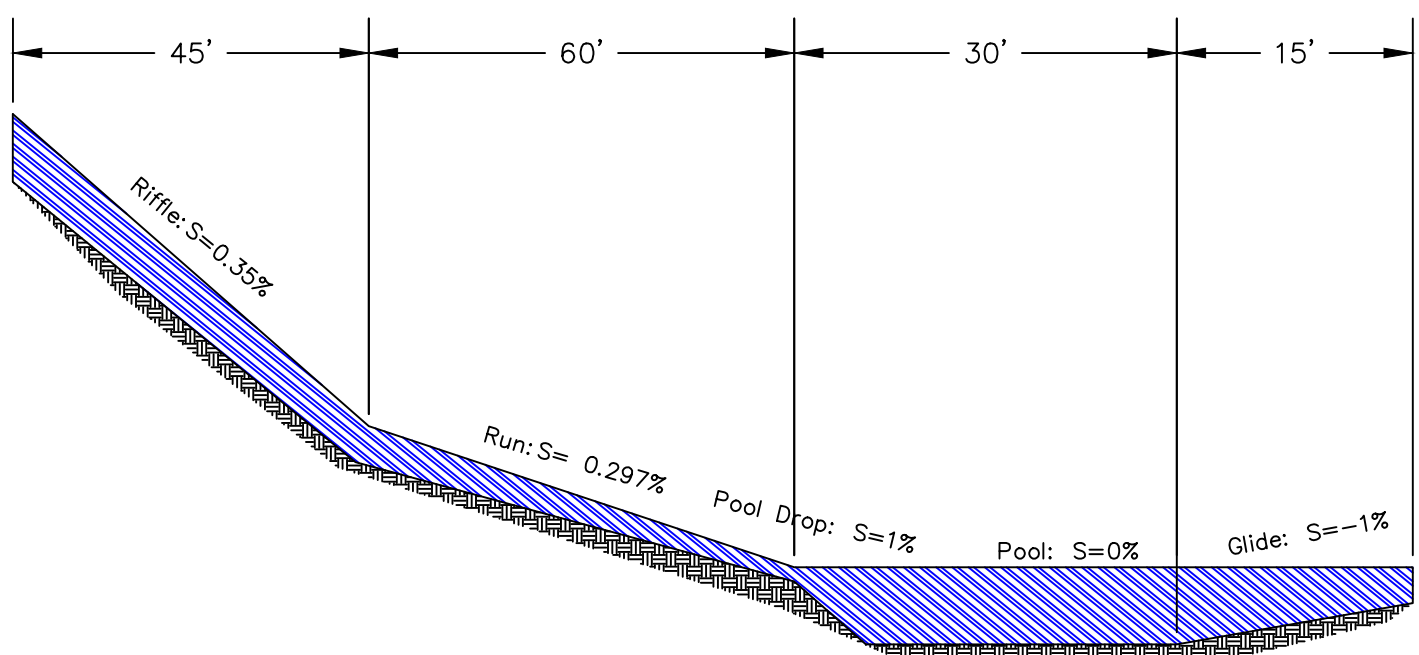

PROJECT:

DATE: 4/21/2020

BY:HYD ENGINEERING

DRAWING:

SINCLAIR WASH FEASIBILITY STUDY

SCALE:NOT TO SCALE

TYPICAL PROFILES

PAGE:3

OF:10

Site 1 Typical Geometry

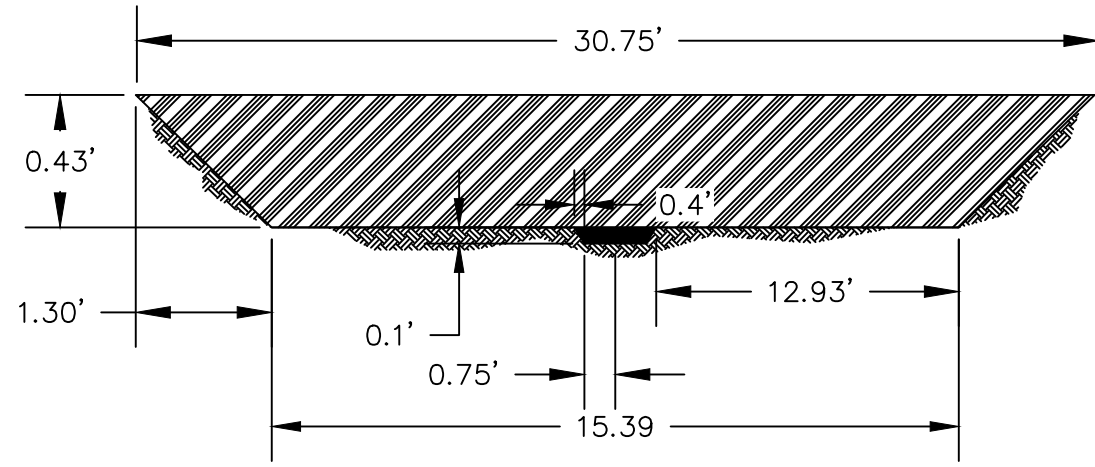

Site 2 Typical Geometry

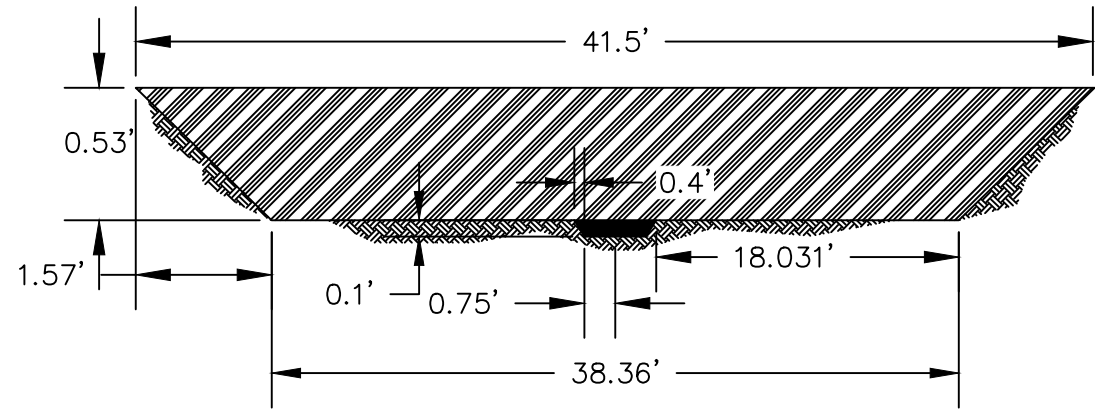

Site 3 Typical Geometry

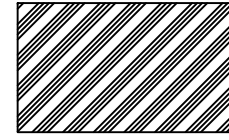
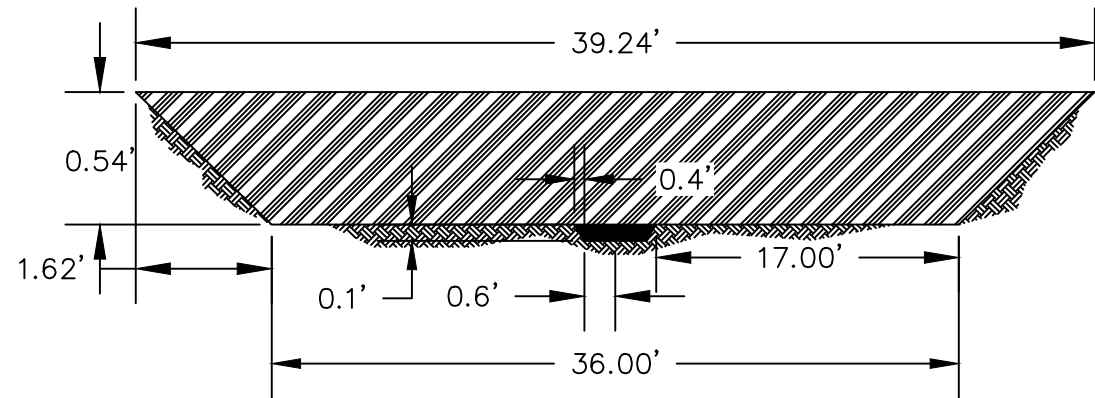

Bankfull Area



Inner Berm

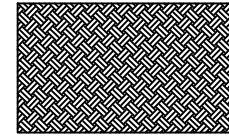

Channel Bed

DRAWING:

TYPICAL GEOMETRY

PAGE:4

OF:10

BY:HYD ENGINEERING

DATE: 4/21/2020

PROJECT:

SCALE:NOT TO SCALE

SINCLAIR WASH FEASIBILITY STUDY

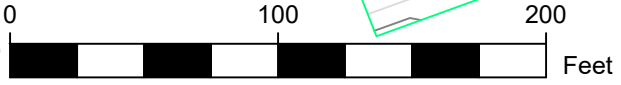
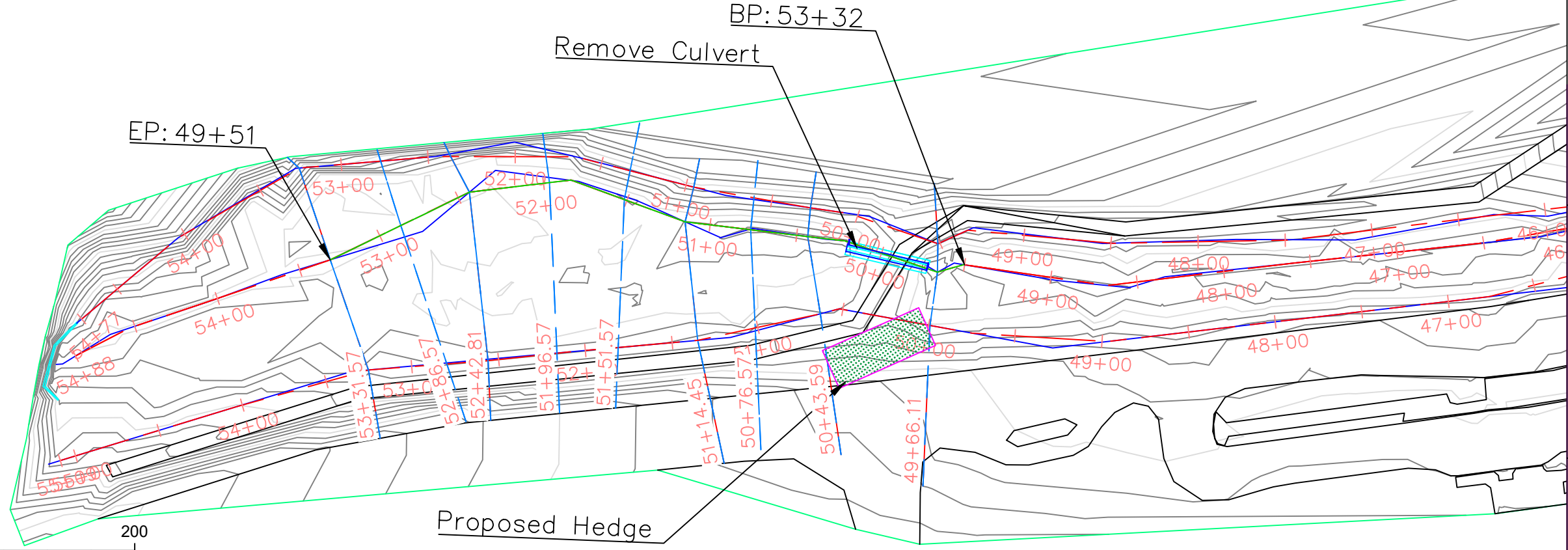

PRODUCED BY AN AUTODESK STUDENT VERSION

Thalweg PROFILE

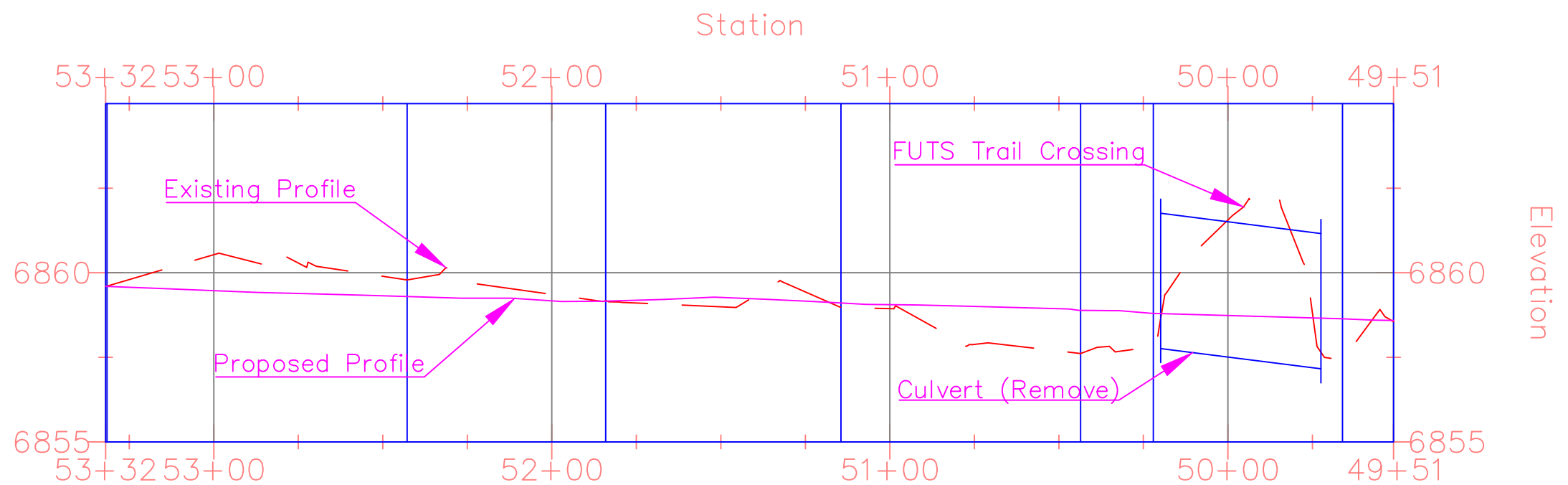

DRAWING:	TYPICAL GEOMETRY
	PAGE:5 OF:10
BY:HYD ENGINEERING	SCALE:NOT TO SCALE
DATE: 4/21/2020	PROJECT:
SINCLAIR WASH FEASIBILITY STUDY	

PRODUCED BY AN AUTODESK STUDENT VERSION

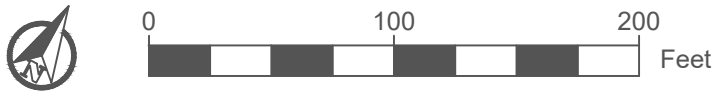
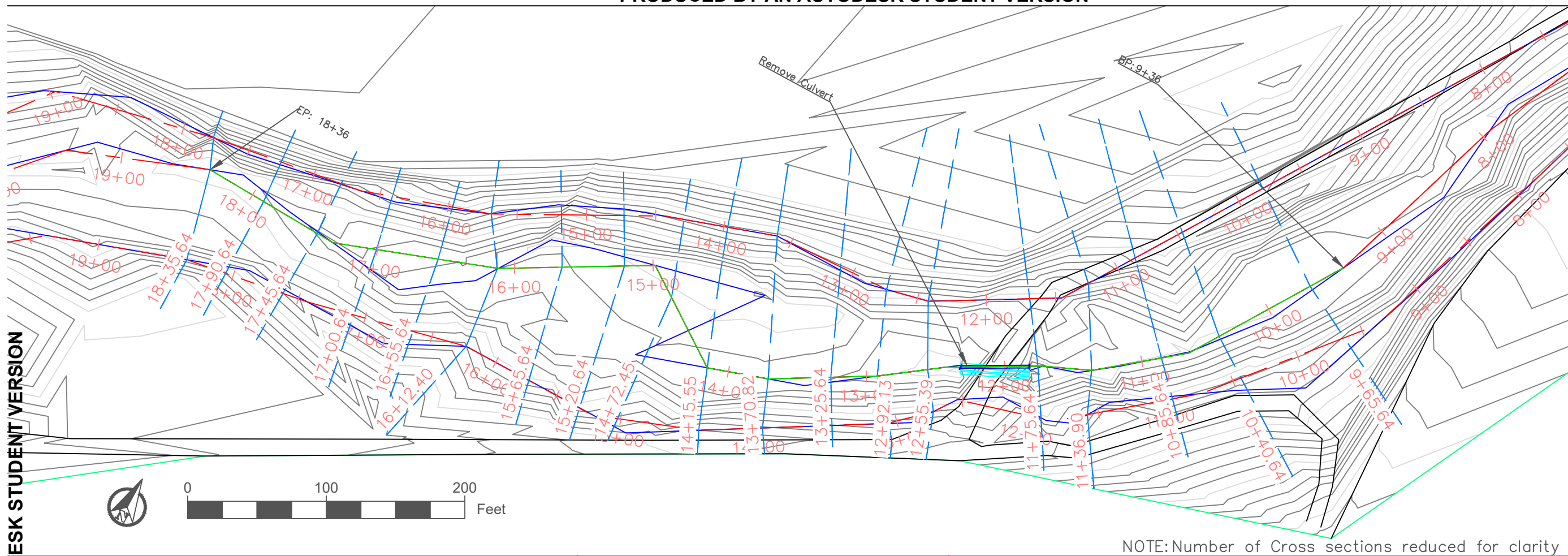

NOTE: Number of Cross sections reduced for clarity

Thalweg PROFILE

Station

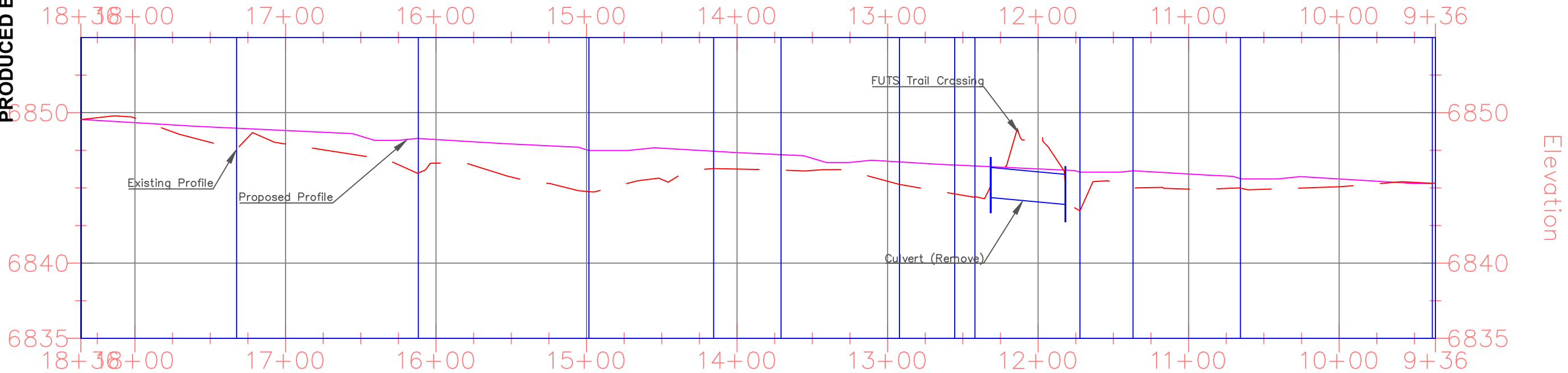

PRODUCED BY AN AUTODESK STUDENT VERSION

PRODUCED BY AN AUTODESK STUDENT VERSION

DRAWING:	TYPICAL GEOMETRY	OF:10
	BY:HYD ENGINEERING	PAGE:6
DATE: 4/21/2020	SCALE:NOT TO SCALE	
PROJECT:	SINCLAIR WASH FEASIBILITY STUDY	

PRODUCED BY AN AUTODESK STUDENT VERSION

PRODUCED BY AN AUTODESK STUDENT VERSION

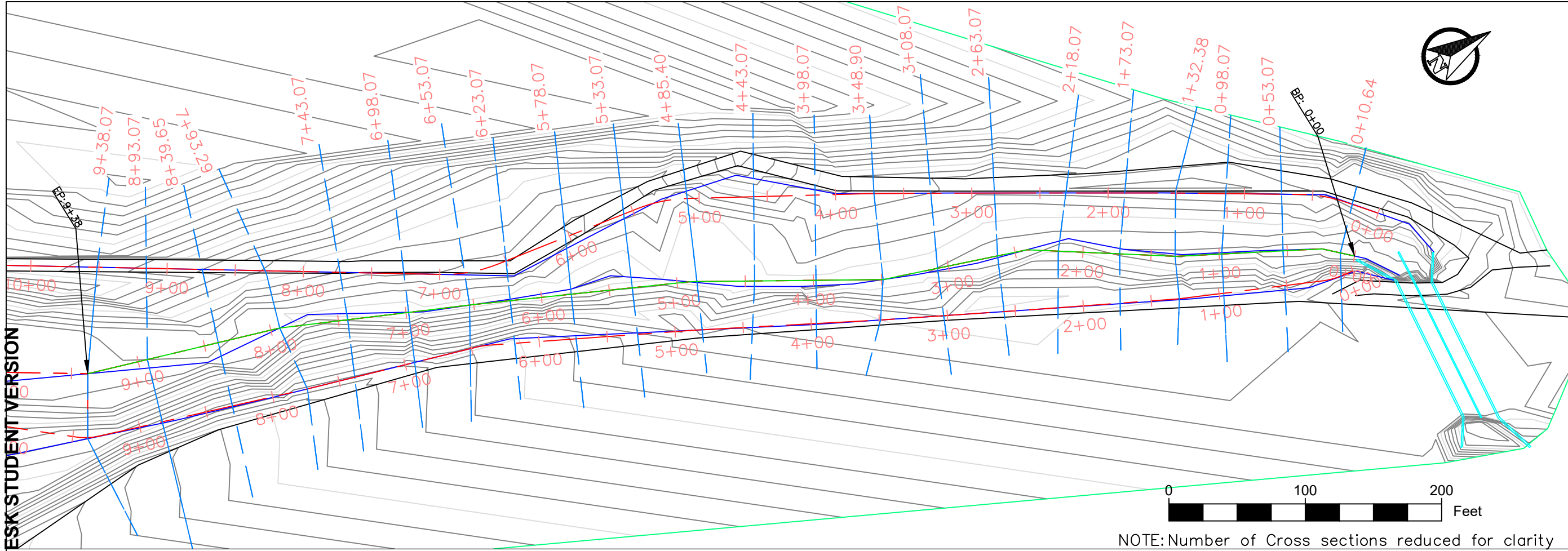

Thalweg PROFILE

Station

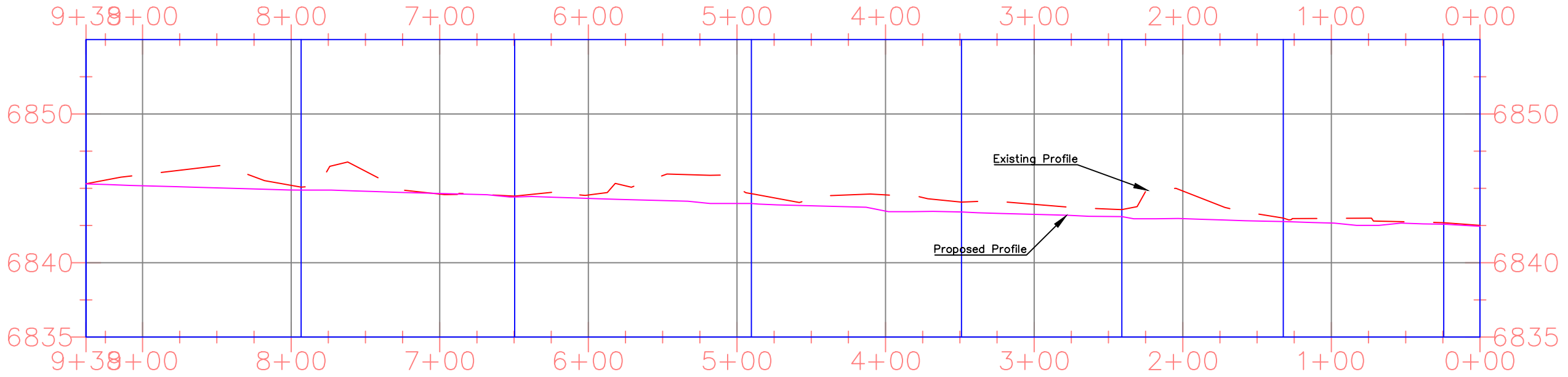

DRAWING:	TYPICAL GEOMETRY	
	PAGE:7	OF:10
BY:HYD ENGINEERING	SCALE:NOT TO SCALE	
DATE:4/21/2020	PROJECT:	
SINCLAIR WASH FEASIBILITY STUDY		

PRODUCED BY AN AUTODESK STUDENT VERSION

Site 1 riffle cross section
STA 5316.57

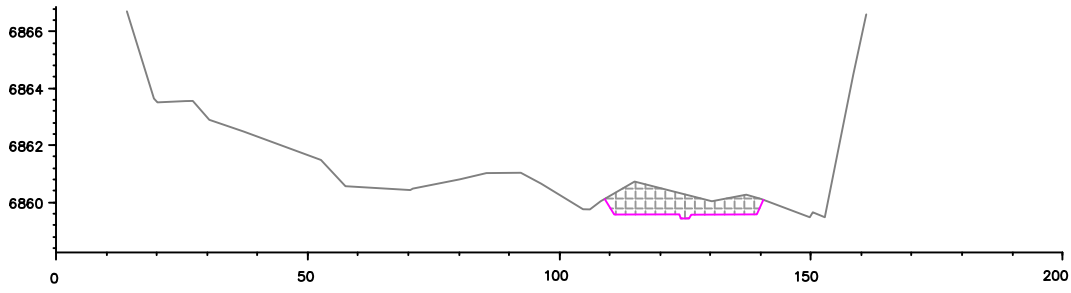

Site 1 riffle cross section
STA 5043.59

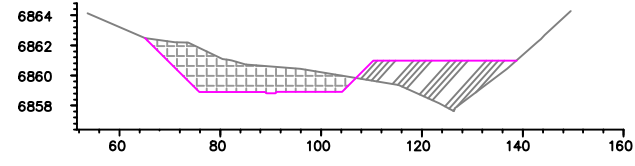

Site 1 riffle cross section
STA 4956.57

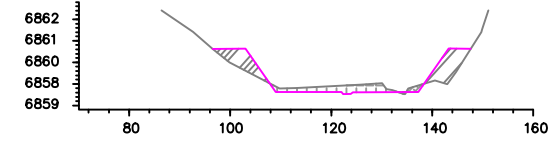

Site 1 run cross section
STA 5271.57

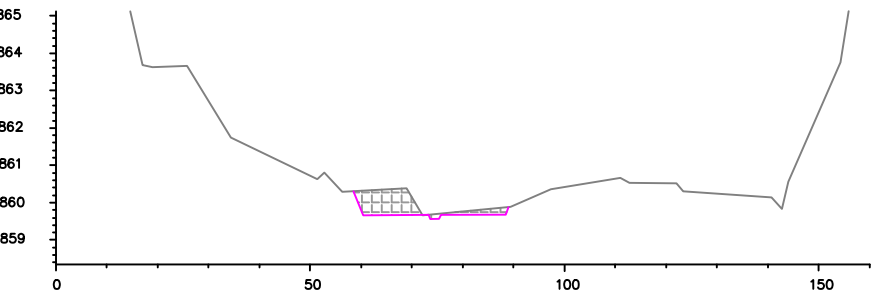

Site 1 run cross section
STA 5091.57

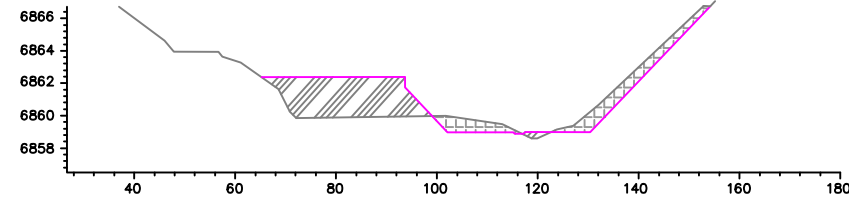

Site 1 run cross section
STA 5022.06

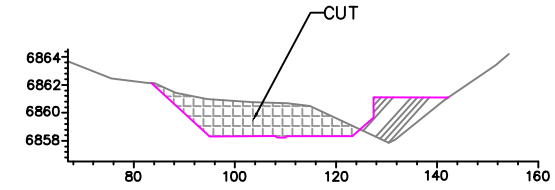

Site 1 pool cross section
STA 5211.57

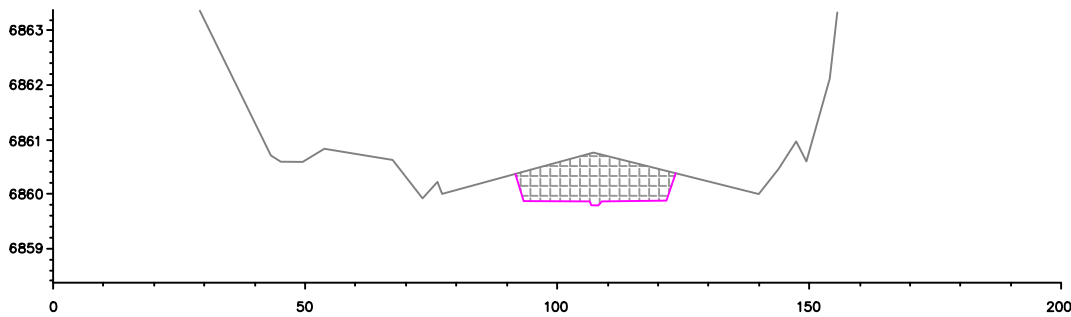

Site 1 pool cross section
STA 5196.57

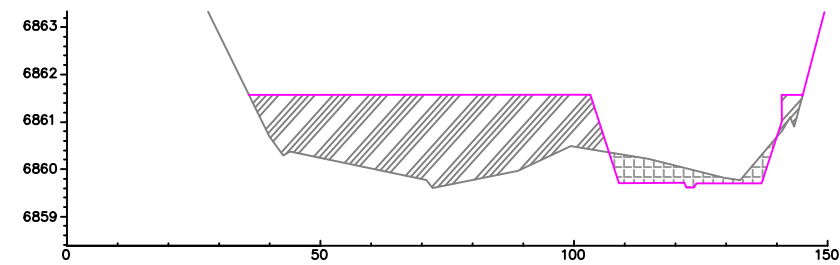

Site 1 glide cross section
STA 5184.06

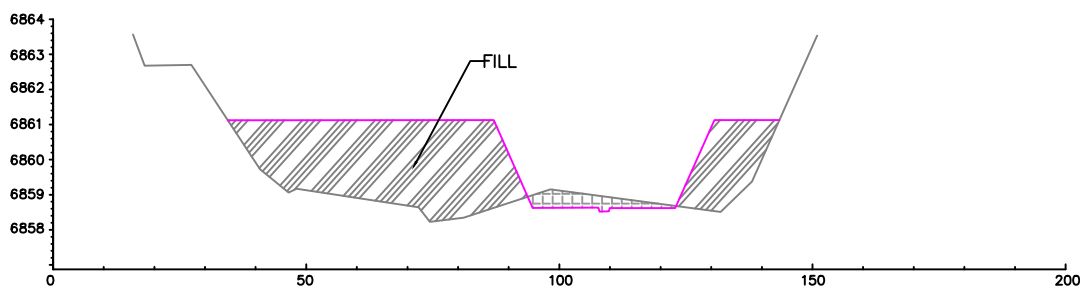

Site 1 glide cross section
STA 5166.67

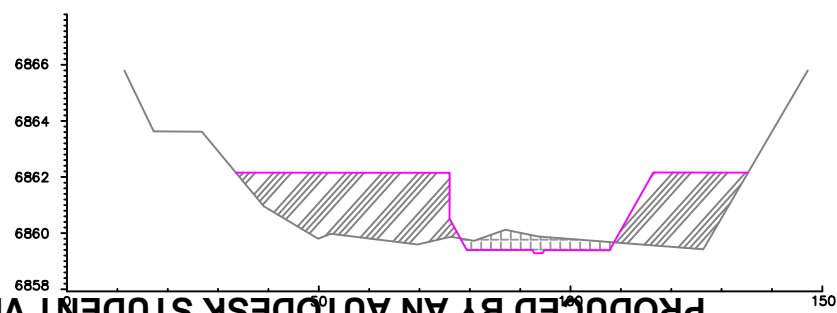

DRAWING: CROSS-SECTIONS	SITE 1	BY: HYD ENGINEERING	DATE: 4/21/2020	PROJECT:	OF: 10
					PAGE: 8
SCALE: NOT TO SCALE				PRODUCED BY AN AUTODESK STUDENT VERSION SINCLAIR WASH FEASIBILITY STUDY	

PRODUCED BY AN AUTODESK STUDENT VERSION

Site 2 riffle cross section
STA 1790.64

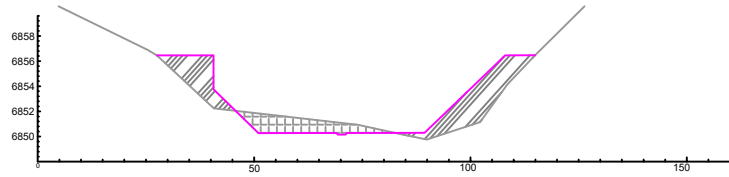

Site 2 riffle cross section
STA 1415.55

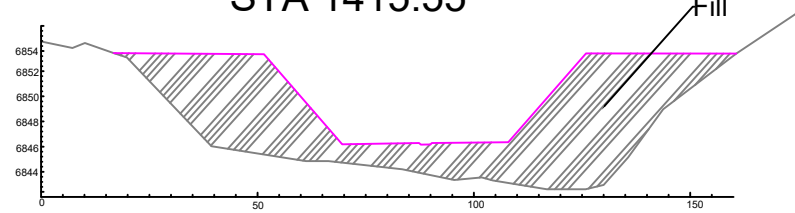

Site 2 riffle cross section
STA 1100.64

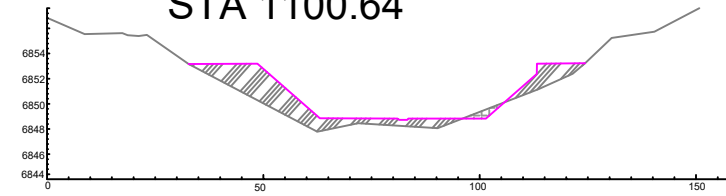

Site 2 run cross section
STA 1700.64

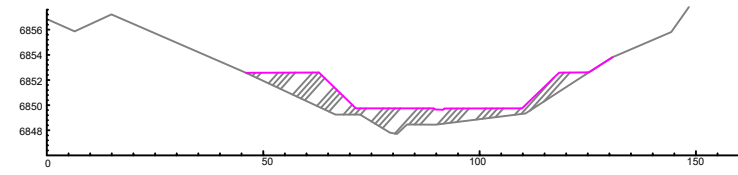

Site 2 run cross section
STA 1370.82

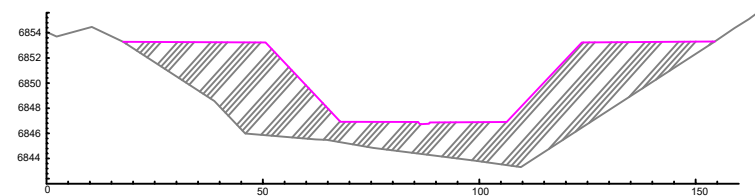

Site 2 run cross section
STA 1070.64

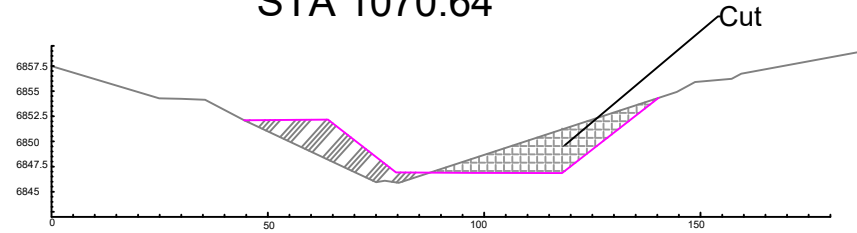

Site 2 pool cross section
STA 1625.64

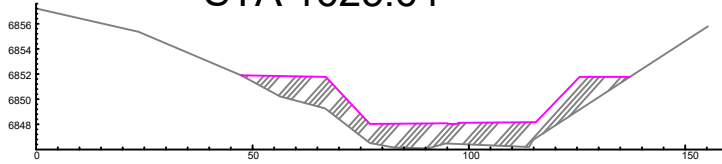

Site 2 pool cross section
STA 1325.64

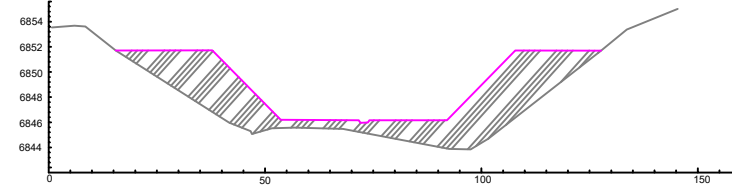

Site 2 pool cross section
STA 1040.64

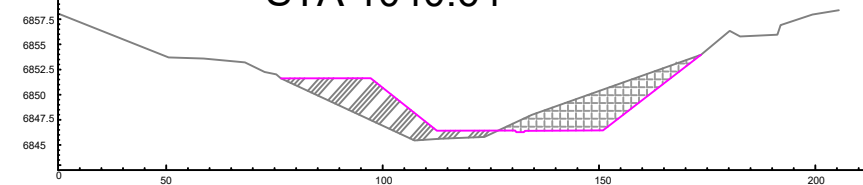

Site 2 glide cross section
STA 1612.4

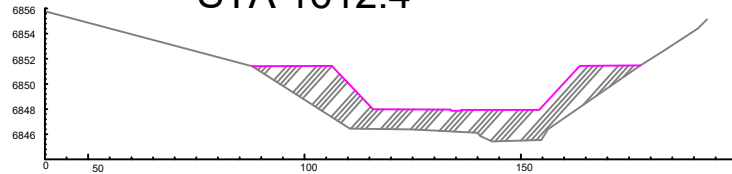

Site 2 glide cross section
STA 1310.64

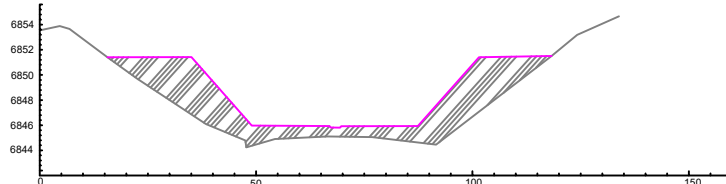

Site 2 glide cross section
STA 1025.64

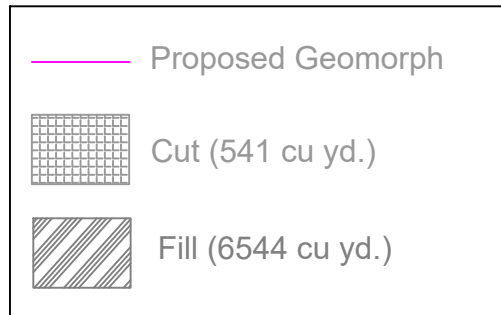
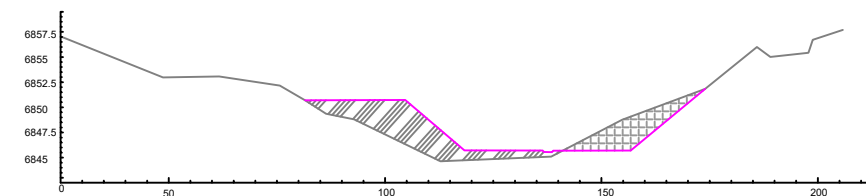

DRAWING:
CROSS-SECTIONS
SITE 2

PAGE:9
OF:10

BY:HYD ENGINEERING

SCALE:NOT TO SCALE

DATE: 4/21/2020

PROJECT:

SINCLAIR WASH FEASIBILITY STUDY

PRODUCED BY AN AUTODESK STUDENT VERSION

PRODUCED BY AN AUTODESK STUDENT VERSION

PRODUCED BY AN AUTODESK STUDENT VERSION

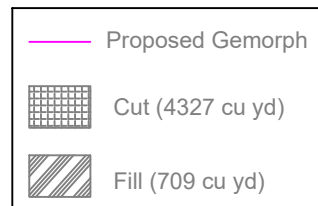
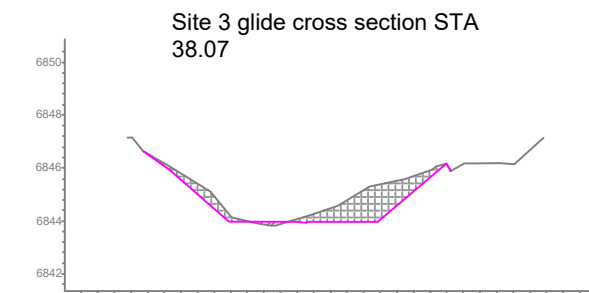
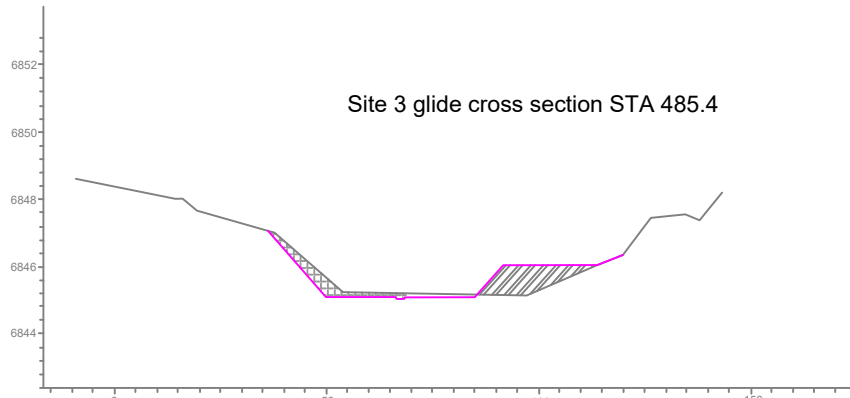
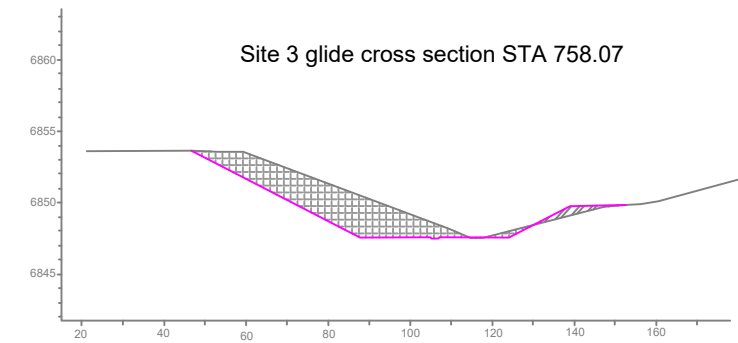
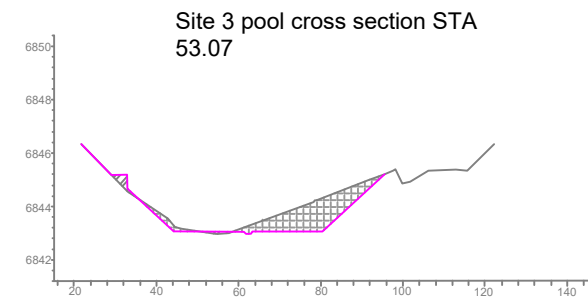
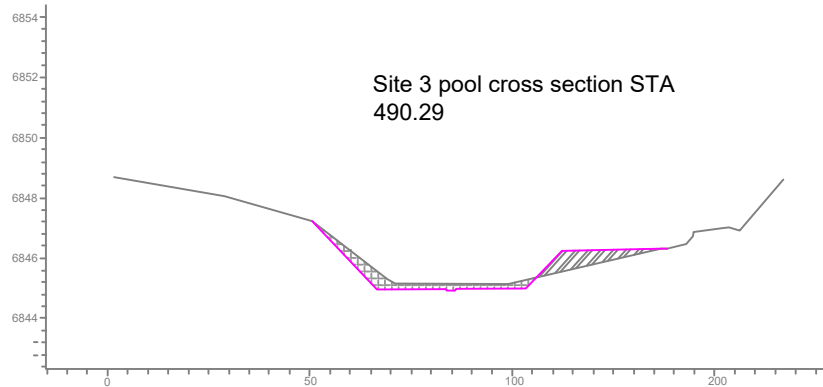
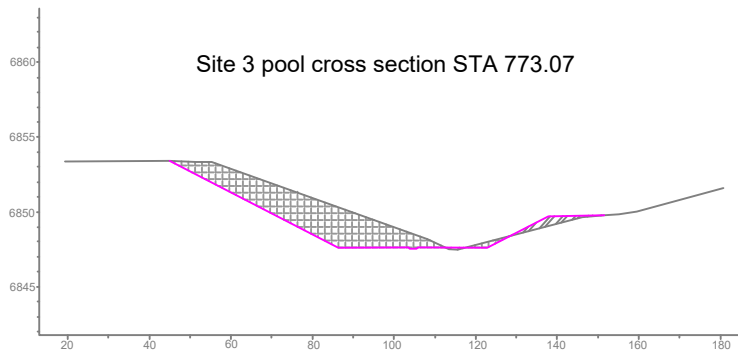
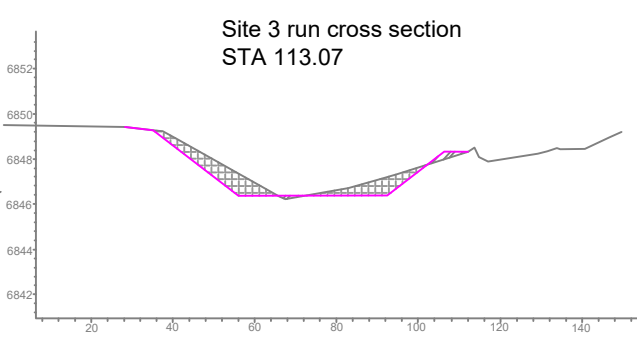
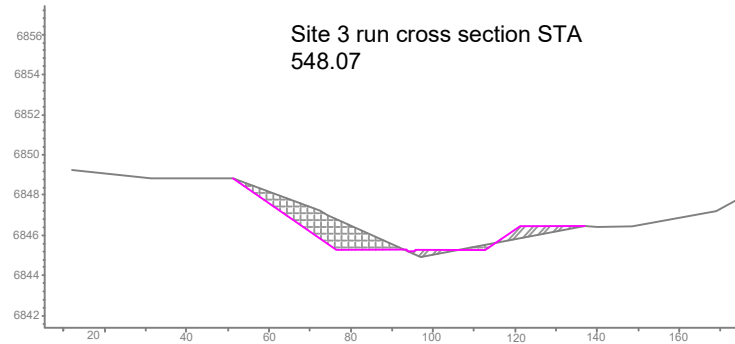
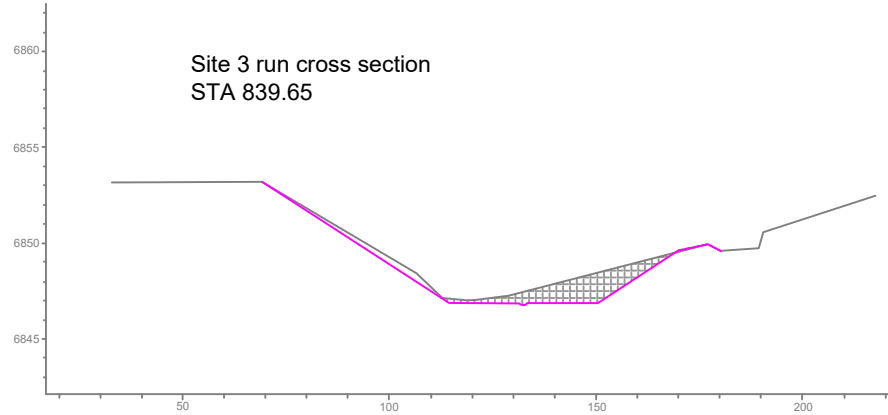
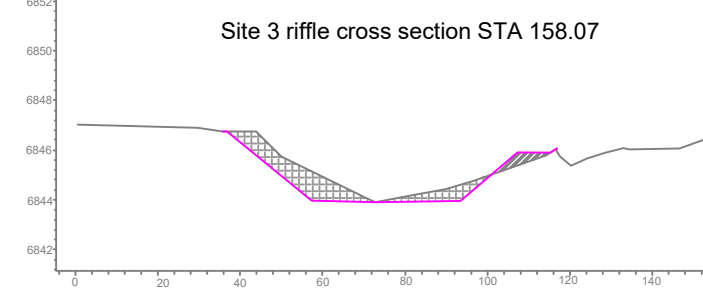
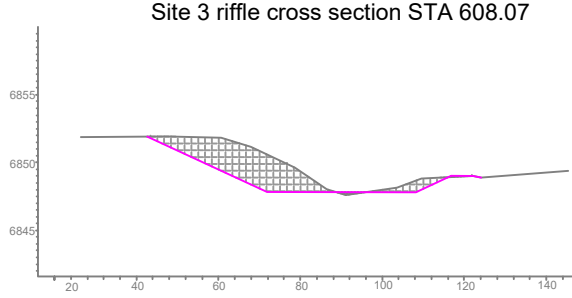
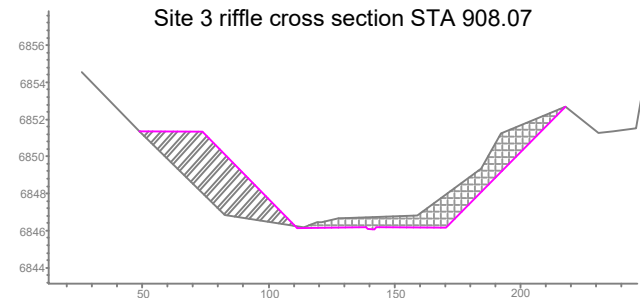

DRAWING:
CROSS-SECTIONS
SITE 3

BY: HYD ENGINEERING

DATE: 4/21/2020

PROJECT:

SCALE: NOT TO SCALE

SINCLAIR WASH FEASIBILITY STUDY

PAGE: 10 OF: 10

PRODUCED BY AN AUTODESK STUDENT VERSION